

KOMAC SPECIAL ATTACHMENTS

Korea machine co.,ltd.

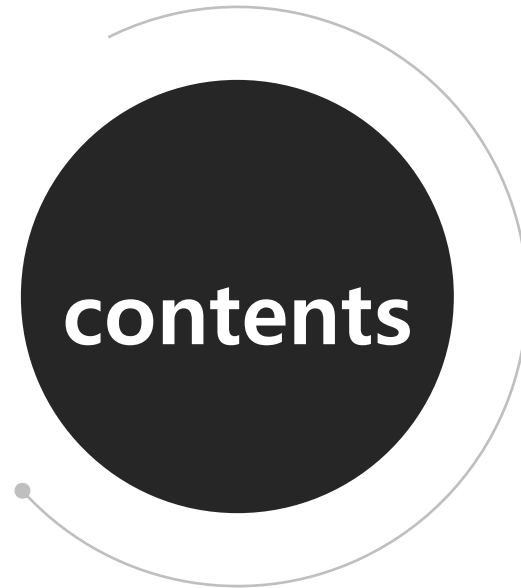



1. 2nd & 3rd MEMBER SHEAR
2. PILE DRIVER
3. VIBRATING RIPPER

STEP. 1 2nd & 3rd MEMBER SHEAR

2nd MEMBER SHEAR



3rd MEMBER SHEAR



STEP. 1 2nd & 3rd MEMBER SHEAR

- SPECIFICATION

KOMAC

Technology with Passion

Model			TRIS20TMS	TRIS30TMS	TRIS40TMS
Excavator weight		ton/lb	19~26 / 41,900~57,000	27~36 / 59,500~79,300	27~50 / 59,500~110,000
Unit Weight		ton/lb	2.3 / 5,100	3.3 / 7,300	5 / 11,000
Max. Pressure	Jaw	bar/psi	350 / 5,000	350 / 5,000	350 / 5,000
	Rotation		120 / 1,700	120 / 1,700	150 / 2,200
Max. Flow	Jaw	lpm/gpm	200 / 52	250 / 66	380 / 100
	Rotation		30 / 8	30 / 8	45 / 12
Cutting Force	at cutter tip	ton/lb.f	100 / 200,500	135 / 297,600	200 / 440,900
	at throat	ton/lb.f	400 / 881,800	550 / 1,212,500	800 / 1,763,700
Max. Jaw Opening		mm/ft-in	510 / 20.1	620 / 24.4	705 / 27.8
Max. Jaw Depth		mm/ft-in	510 / 20.1	600 / 23.6	705 / 27.8
Steel Cutting Capacity	I-Beam	mm	300x150x8x13	400x150x10x20	500x300x11x18
	H-Beam	mm	200x200x6x9	250x250x10x15	400x400x13x21
	Pipe	mm/in	350x6 / 14x0.2	450x8 / 18.03	560x10 / 22x0.4
	Round Bar	mm/in	70 / 2.7	85 / 3.3	110 / 4.3
	Plate	mm/in	16 / 0.6	20 / 0.7	30 / 1.2
	Concrete	mm/in	350 / 15	450 / 18	600 / 23.6

I-Beam & H-Beam : Height x Width x Thickness x Thickness

Pipe : Outer Diameter x Thickness

Round Bar : Diameter

Plate & Concrete : Thickness

STEP. 2 PILE DRIVER



- 1 | WIDE RANGE OF CONSTRUCTION AREAS
- 2 | ROTATING MOUNTING BRACKET
- 3 | QUICK HYDRAULIC INSTALLATION
- 4 | INTUITIVE DESIGN
- 5 | OPTIONAL EXTENSION BOOM

Motor
Piston motor with high efficiency



Bearing
Customized design
completely resistible
under high vibration force



Vibration-Proof Rubber
Improve durability with
vibro-isolating rubber



Jaw
Tight clamping and easy moving

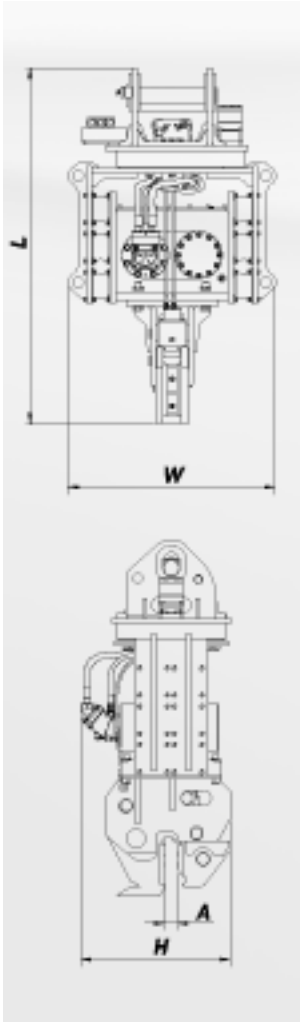

STEP. 2 PILE DRIVER

- SPECIFICATION

Model	Unit	KPD250	KPD300	KPD400
Suitable Excavator	ton	18~26	25~35	34~45
Frequency	bpm	2,800~3,500	2,500~3,500	2,000~2,700
Eccentric Moment	nm/in lbs	66 / 584	80 / 708	100 / 885
Centrifugal Force	kgm	450	500	550
Amplitude	mm	12	14	16
Max. Oil Pressure	bar	350	350	350
(Min. Setting Pressure)		(300)	(300)	(300)
Max. Oil Flow	lpm	200	240	260
Slewing	degree	360	360	360
Weight	kg	1,550	1,850	2,100
Ext. Boom Weight	kg	580	700	870
(Incl. Mounting Cap)				
Clamp Width	mm	65	65	65
Dimension	mm	1,840x1,040x750	1,900x1,100x790	1,920x1,190x840
(L x W x H)				

STEP. 3 VIBRATING RIPPER



- 1 | 3 TO 5 TIMES HIGHER PRODUCTION
- 2 | MINIMUM NOISE LEVELS
- 3 | MINIMUM MAINTENANCE
- 4 | LESS FUEL CONSUMPTION PER PRODUCED M3 / TON
- 5 | MARINE / UNDERWATER OPERATION

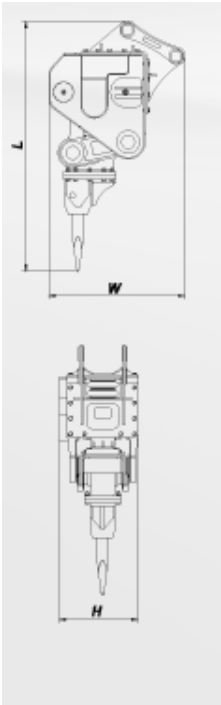
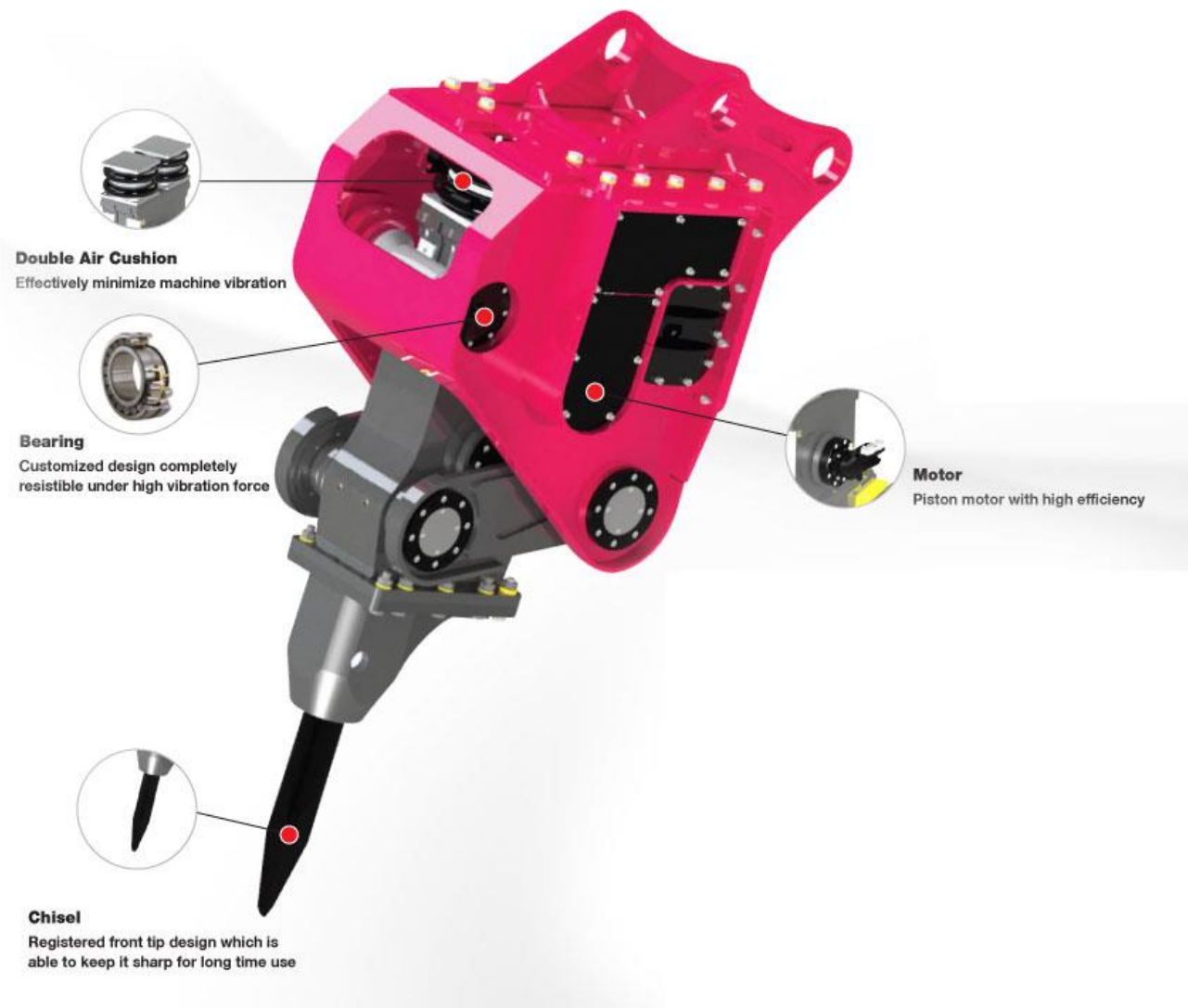

STEP. 3 VIBRATING RIPPER

- SPECIFICATION

Model	Unit	KV20	KV30	KV40
Suitable Excavator	ton	18~26	25~35	34~45
Frequency	bpm	2,800~3,500	2,500~3,500	2,000~2,700
Weight	kg	2,900	3,900	4,900
(Ind. Mounting Cap)				
Max. Oil Pressure	bar	350	350	350
(Min. Oil Pressure)		(300)	(300)	(300)
Return Pressure	bar	6	6	6
Max. Oil Flow	lpm	200	240	260
Dimension	mm	2,720x1,370x880	3,000x1,555x945	3,365x1,682x1,033
(L x W x H)				
Tool Diameter	mm	130	140	150